

DATASHEET

Self-supporting Aerial FTTH Drop Cable Patch cord/ Pigtail

Best cable Solution in FTTH 's Project



OMC INDUSTRY CO.LIMITED



Description

It's a kind of patch cable but assembly with **Self-supporting Aerial FTTH Drop Cable**. This is a last cable in FTTH project. Used widely between Fact plate, terminal box, ONU tec. With easy accessibility to the fiber and simple installation, FTTH cable can be directly connected to the homes. It is suitable for connecting with communication equipment and used as access building cable in premises distribution system. The optical fibers are positioned in the center of cable and two parallel Fiber Reinforce Plastic (FRP/KFRP/Steel wire) strength members are placed at the two sides. Then, the cable is completed with LSZH sheath. Also, customers can specify your required connectors.

Optical performance.

Test Item		Test Condition	Value(dB)	
			UPC	APC
Optical Performance	Insertion Loss	1310nm LED light source	<0.3	<0.3
	Return Loss	1310nm LED light source	>50	>60
Environmental Performance (Max. Insertion Loss change)	High temperature	+85°C168 hours	<0.2	
	Temperature Cycle	-40-+75°C, 21 Cycles 168 hours	<0.2	
	Humidity Aging	+75°C, 95%R.H,168 hours	<0.2	
	Humidity/ Condensation Cycling	-10°C-+65°C, 90%~100%RH, 14 cycles 168 hours	<0.2	
Mechanical Performance (Max. Insertion Loss change)	Vibration	10-55Hz, 1.5mm(p-p)	<0.2	
	Flex	0.9kg,-90°~+90° repeat for 100 cycles	<0.2	
	Torsion	1.35kg,90°~+90° ,10times	<0.2	
	Withstand tensile	90N,10min	<0.2	
	Drop	H=1.5M,Total of 8 drops	<0.2	
	Exchangeability	Randomly	<0.2	
	Durability	500 times	<0.2	

End-face Quality (SM)

Zone	Range (μm)	Scratches	Defects	Reference
A: Core	0 to 25	None	None	IEC 61300-3-35:2015
B: Cladding	25 to 115	None	None	
C: Adhesive	115 to 135	None	None	
D: Contact	135 to 250	None	None	
E: Rest of ferrule		None	None	

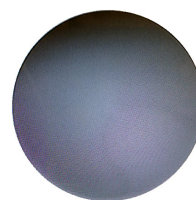

SM APC



SM UPC



Self-supporting Aerial FTTH Drop Cable Patch cord/pigtail

Cable structure

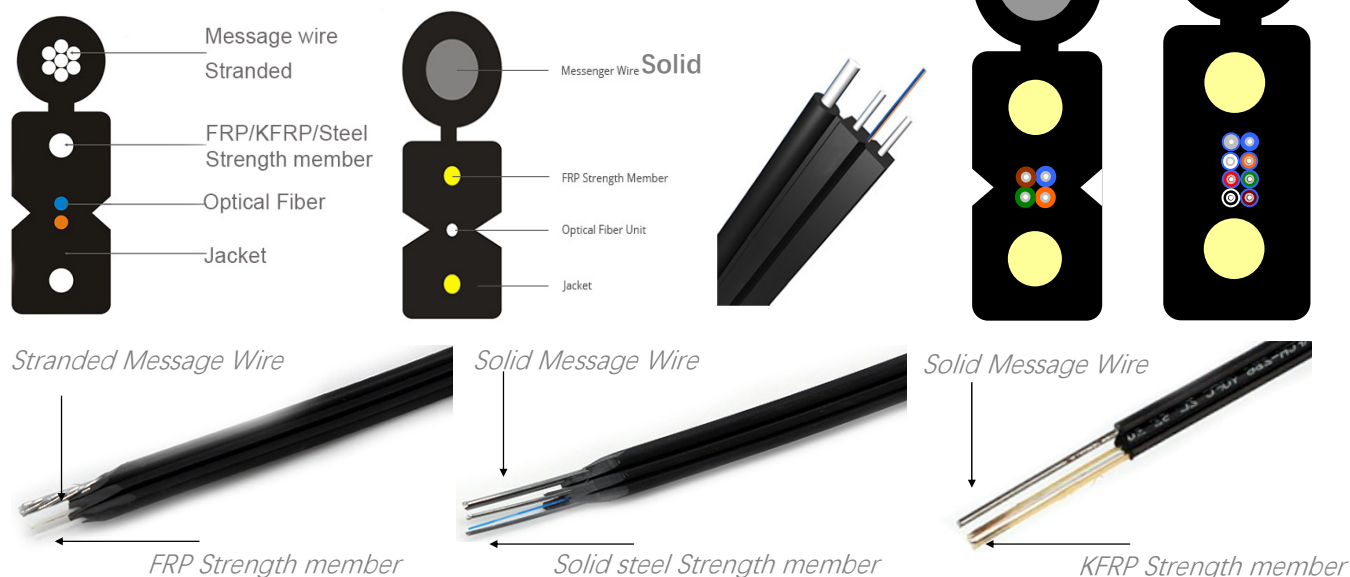

Technical Data:

Fiber Count	1F	2F	4F/6F	8F/12F
Self-supporting Strength member	Solid Steel wire/ Stranded Steel wire			
	1.0mm			1.2mm
Strength member	FRP/KFRP/Solid Steel wire			
	0.45-0.52mm	0.45-0.52mm	0.45-0.52mm	0.45-0.52mm
Cable diameter(mm) Approx.	2.0*5.0(±0.1)	2.0*5.0(±0.1)	2.0*5.0(±0.1)	2.8*6.3(±0.1)
Cable weight(kg/km) Approx	18.5/20	19/20.5	20/21.5	34/35
Tensile Strength Short/ Long Term(N)	200/100 for steel wire strength member 80/40 for KFRP wire strength member			
Crush resistance short/long term (N/100mm)	1000/500			
Operating temperature range(°C)	-40°C ~+70°C			

Connector's Standard:

SC: TIA/EIA, FOCIS3, GR-326.NTT-SC IEC61754-4 and JIS C5973.

LC: TIA/EIA, FOCIS10, GR-326 EIA/TIA-604-10, IEC61754-20 and JIS C5973.

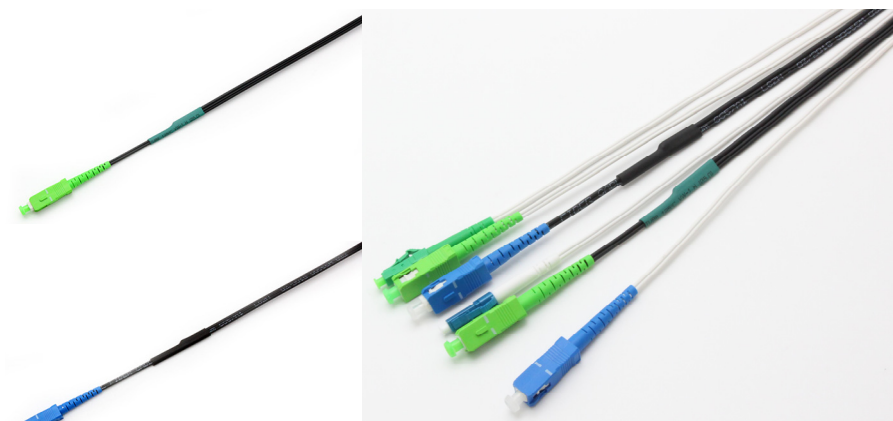

High quality SM Ceramic ferrule,
Good concentricity<0.5um



Self-supporting Aerial FTTH Drop Cable Patch cord/pigtail

Feature:

Good mechanical and environmental characteristic
Simple structure, light weight and high practicability
Low smoke zero halogen and flame retardant sheath
Novel flute design, easily strip and splice, simple installation and maintenance
Two parallel FRP strength members ensure good performance of anti-electromagnetic and crush resistance
Special low-bend-sensitivity fiber provides high bandwidth and excellent communication transmission property

Application

Access Networks
LAN (Local Area Network)
Fiber Optic Communication System
FTTH (Fiber to The Home) Indoor Building
Optical fiber connected and transmitted equipment

Ideal Solution by FTTH Indoor Fiber Patch Cable

A high-capacity FTTH network gives you opportunities to build a competitive advantage and maintain an eco-sustainable network that consumes less power. With simple structure and light weight, self-supporting FTTH drop cable is highly recommended for the connection of outdoor and indoor cabling.

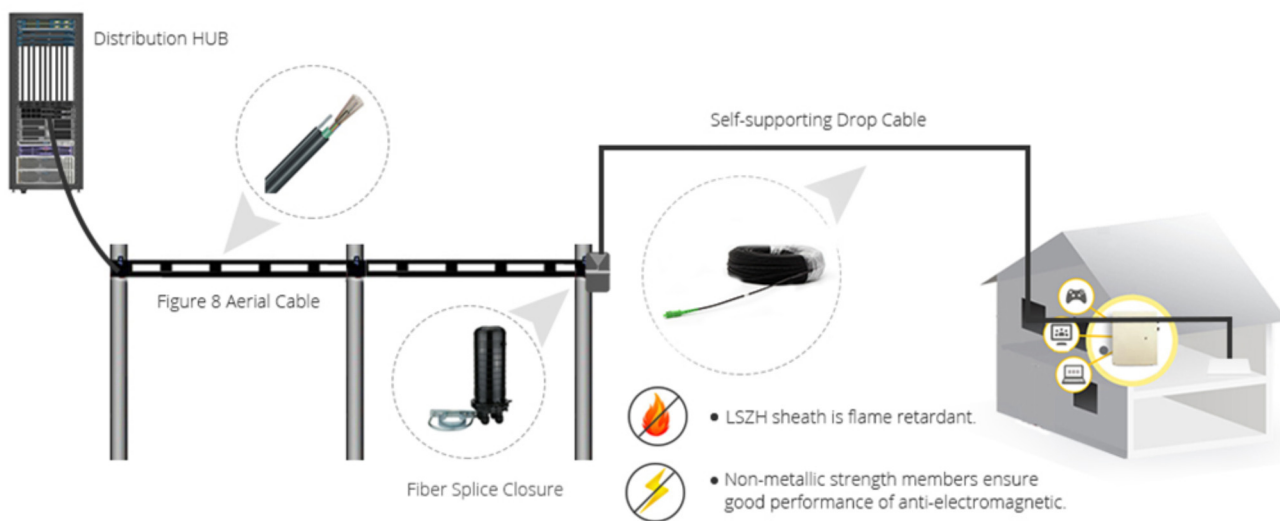

Packaging

This easily taken and well-protected fiber patch cable package has been labelled and marked by OMC as de-fault. Standard carton size : 34*22*15 cm; 44*34*24 cm ; 54*39*34 cm . Which carton to be used depends on goods Qty . Packing can be customized.



1, Film wrap



2, Paper Carton



3, fumig-free Pallet



Self-supporting Aerial FTTH Drop Cable Patch cord/pigtail

OME service

1. Cable color, printing word, material of cable jacket, connector's color
2. OEM Label, Identify ring, cable's label, box, shipping marks
3. Different quality Level.

Order Instruction

Products	Fiber Count	Fiber Mode	Connector A	Connector B	Strength Member	Color	length
C	1- 1 core	1- G657A1	A LC UPC	O Open(pigtail)	1 2 x FRP Wire	A- Blue	
Drop cable	2 -2 cores	2- G657A2/B2	B SC UPC	A LC UPC	2 2 x KFRP Wire	B- Orange	
patch cord	4-4cores	3 - G657B3	C LC APC	B SC UPC	3 2 x Steel Wire	C- Green	
and pigtail	6-cores	4-OM1	D SC APC	C LC APC	A 1 x Solid Steel Wire+2 x FRP Wire	D- Brown	
	8-cores	5-OM2	E FC UPC	D SC APC	B 1 x stranded Steel Wire+2 x FRP Wire	E- Grey	
	T-12cores	6-OM3	F FC APC	E FC UPC	C 1 x Solid Steel Wire+2 x KFRP Wire	F- White	
		7-OM4	G SC APC+SC UPC	F FC APC	D 1 x stranded Steel Wire+2 x KFRP Wire	G- Red	
		8-OM5	H SC APC+LC UPC	G SC APC+SC UPC	E 1 x Solid Steel Wire+2 x Solid Steel Wire	H- Black	
			I SC APC+LC APC	H SC APC+LC UPC	F 1 x stranded Steel Wire+2 x Solid Steel Wire	I- Yellow	50=50M
			J SC APC+SC APC	I SC APC+LC APC		J- Purple	
			K SC UPC+LC UPC	J SC APC+SC APC		K- Pink	
			L SC UPC+LC APC	K SC UPC+LC UPC		L- Aqua	
			M SC UPC+SC APC	L SC UPC+LC APC		M-Magenta	
			O SC UPC+SC UPC	M SC UPC+SC APC			
			P LC UPC +LC UPC	O SC UPC+SC UPC			
			Q LC UPC +LC APC	P LC UPC +LC UPC			
				Q LC UPC +LC APC			